



UK Flowtechnik

Specialists in flow metering, pumps, couplings
and process measurement equipment

PRODUCT DATASHEET



UK Flowtechnik Ltd
1 Central Park
Lenton Lane
Nottingham
NG7 2NR
United Kingdom

Phone +44 (0) 11 59 01 71 11
UK Free Phone 0800 4334 770
Fax +44 (0) 11 59 86 88 75

sales@ukflowtechnik.com
www.ukflowtechnik.com

ClearView OEM Series Flowmeter



These OEM flowmeters are cost effective and ideal for cooling water application such as those found on moulding and casting machines or for balancing heating and cooling circuits. They are moulded in clear Polycarbonate or Polysulfone and have a distinctive white float with a black line to indicate flow against a linear scale, taking the guess work out of looking over the top of the float and reducing parallax errors. With union ends and threaded connections in Polysulfone (for economy or demin water applications) or Brass for durability the CV series is simple to install and maintain. The bonus of the see-through body is the ability to monitor the fluid condition without having to install a separate sight glass.

For oil applications the CV Series can be used for return lines, case drains or low-pressure bearing lubrication. They are viscosity compensated up to 110 cSt which means most common grades of hydraulic oil such as ISO VG32 and 46 at ambient temperatures and above can be measured.

Features & Benefits

- Economic design, ideal for OEM machine builders
- Can be mounted vertically or horizontally
- Only 200mm long with either Polysulfone or Brass ends
- Clear indication of flow rate

Technical Data

	05	10	15	30
Flow Range l/min	2-20	4-40	4-57	11-110
Connection Size	1/2", 3/4", 1"			3/4", 1" only
Body Material	Polycarbonate or Polysulfone			
Spring & internal clip Material	Stainless Steel			
End Connection Material	PPS or Brass			
Seals	Viton			
Linearity	+/- 2% FSD			
Max Pressure (Bar)	22.4 Bar			
Max Temperature (°C)	93 °C (Polycarbonate), 121 °C Polysulfone body			

Dimensional Data

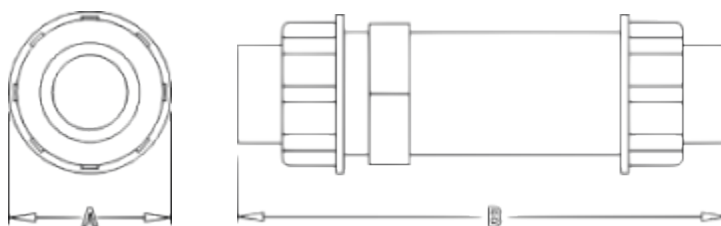

	1/2"	3/4"	1"
A	62		
B (PPS ports)	192		
B (Brass NPT/BSP female)	182	192	
B (Brass NPT male)	194	204	208

Ordering Information

