



**UK Flowtechnik**

Specialists in flow metering, pumps, couplings  
and process measurement equipment

# Hydraulic Components

**Drive couplings**

**Bellhousings**

**Oil tanks & accessories**

**Tank heaters**

**Heat exchangers & oil coolers**

**Hydraulic gear pumps**

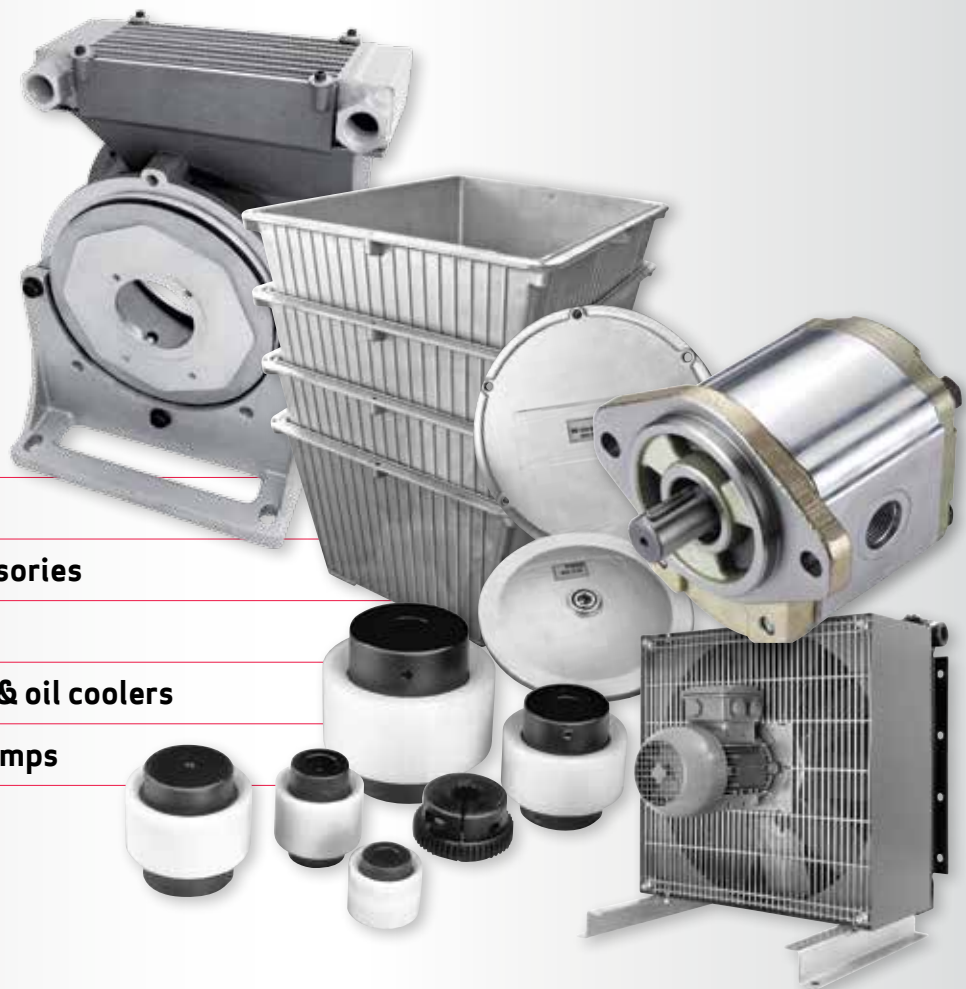

We offer an extensive product range of oil tanks, and a wide variety of hydraulic components and couplings for drive and fluid technology. We ensure absolute reliability, short delivery times and a superior level of customer support.

HBE is one of the leading manufacturers in this field with over 30 years experience and supplies its products worldwide. UK Flowtechnik is the official UK partner.

## HBE P+ Calculator

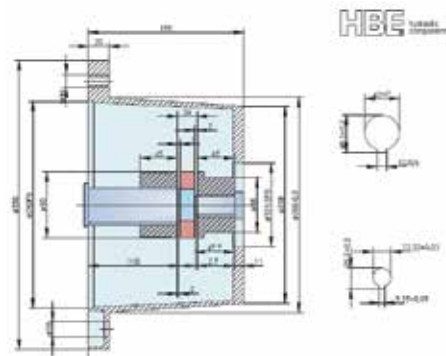

HBE P+Calculator available online for quick and easy selection of bellhousing and couplings.

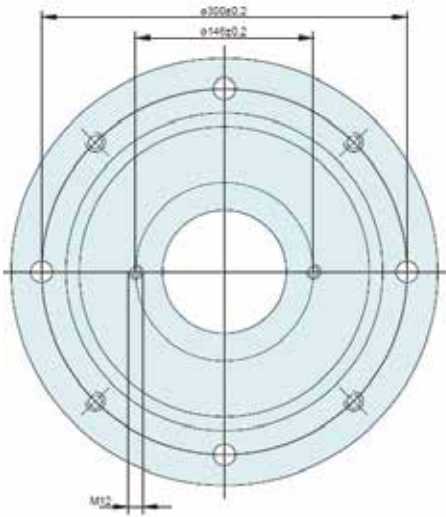

Download and save the drawings in PDF, DXF and 3D Step format files.

## Bellhousings

- Bellhousings, damping elements, foot brackets and accessories for connecting IEC and EMA electric and petrol motors to a huge range of hydraulic pumps
- Standard bellhousings made of aluminium (suitable for ATEX zone 2)
- Bellhousings made of grey iron, steel and stainless steel available on short lead times for ATEX zone 1, offshore and hazardous area applications



## PTÖK® Bellhousing/Cooler

- PTÖK series bellhousing with integrated cooler to suit IEC motors from 0.55kW to 22 kW
- Integrated damping to reduce noise and vibration
- Can be installed vertically as well as horizontally
- Suitable for retrofit applications as the PTÖK is exactly the same length as a standard bellhousing



## Drive Couplings Softex® Spider Couplings

- Industry standard electric motor spider couplings available in aluminium, cast iron, sintered steel, carbon steel and stainless steel
- Large stock programme including metric, imperial, taper and spline bores
- Spider inserts available with a choice of elastomer hardness ratings for increased torque or wider temperature range
- ATEX compliant to Zone 1
- Available in sizes 14 to 110
- ES version for high speed servo motors



## Mounting Accessories

- Aluminium foot brackets for the horizontal installation of motor-bellhousing-pump
- Damping rods and rings to reduce noise and dampen vibrations
- Finish-machined for IEC and NEMA motors with foot brackets available ex stock

## Starex® Nylon Sleeve Couplings

- Double cardanic design accommodates higher levels of misalignment. Axially pluggable with blind assembly
- Stock programme includes metric, imperial, taper and spline bores
- Available in sizes 14 to 80







## Hydraulic Oil Tanks

For over 30 years, HBE has been manufacturing hydraulic oil tanks from its own production facility in Germany. We offer a standard range of tanks and bespoke fabrications according to specific customer requirements.

- DIN standard dimensions
- Oil sumps
- Lid machining
- Standard tank sizes from 40-1000 litres supplied from stock
- Holes for standard filler/breather & sight level gauge included
- Cleaning/access covers fitted
- Tanks up to 20,000 litres are available on short lead-times, with bespoke fabrications to customer drawings



## Steel and Stainless Steel Tanks

- Steel tanks and sumps are sand-blasted and then painted inside and out with oil resistant primer
- Stainless steel tanks are shot-blasted inside and out with glass beads
- Additional bores and welded bosses can be added according to customer drawings. Special paint coatings can also be applied
- Steel tanks can also be supplied without primer if required

## Aluminium Tanks

- Available in sizes from 3.5 to 70 litres
- Steel lids available for all sizes and can be machined according to customer's drawing
- Stackable design for space saving storage and lower freight costs
- Sizes 30 to 70 available with feet or castors
- Oil sumps available for sizes 12 to 70



## Hydraulic Tank Accessories

### Access/Cleaning Covers

- Available in standard sizes 235, 250, 350, 475 and 595
- Made from aluminium, but all sizes also available in steel and stainless steel
- NBR standard seals, also available in viton or EPDM
- Cross-clamping type available in sizes 235 or 345
- Customer logo can be added at low cost



### Oil Level & Level/Temperature Gauges

- Available in 76, 127, 176 and 254mm versions
- Basic level only or level/temperature options available in all sizes
- Powder-coated steel construction
- Application range: -20°C...+ 80°C
- Available with electrical connection in sizes 127 and 254mm

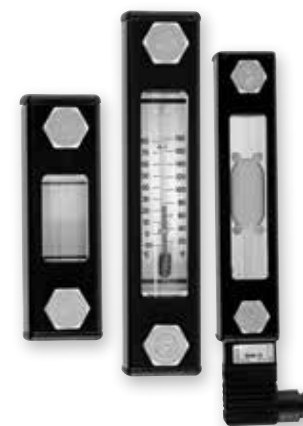

### Filler Breathers

- Standard SE1 and SE2 sizes
- Chrome plated steel (plastic option available on request)
- Filter included to 10 microns



### Float Level Switches

- Available with 1 or 2 level contacts
- Brass stem with nylon float suitable for oil, diesel or petrol
- Available in lengths from 100 to 500mm
- Single float version also available with temperature switch
- Variable switch-contact versions in lengths 500 and 800mm, which can easily be cut down to required length



## Tank Heaters

Our tank heaters are uniquely designed to heat large storage tanks located above or below ground and containing highly viscous fluids or heat sensitive materials. We offer a range of different designs to suit the specific application requirements.

### VR Series Magnetic Clamp Type

- Ideal for retrofit applications
- Stainless steel construction
- 240V mains powered
- Integrated thermostat
- Sizes up to 1kW available from stock
- 24 DC version available for mobile and construction machinery



### Cartridge Sleeve Type

- Recommended for new power units
- PTHK series with interchangeable ceramic heating insert
- RHK series with open element offers cost effective heating for smaller tanks
- Sizes from 380W to 5kW
- G1 1/2" and G2" mounting options
- Single phase or 3 phase, 100V to 440V supply



## Heat Exchangers & Oil Coolers



### Series UKC-G Oil/Water Heat Exchanger

- High performance tube bundle cooler for direct mounting into tank or gearbox by using existing threaded ports for heaters
- Inexpensive and space saving solution with tube side flow rates of up to 25l/min

### Plate Heat Exchangers

- The DOC range of Plate Heat Exchangers offers unparalleled efficiency for hydraulic oil cooling
- Suitable for hydraulic and lube oil systems with cooling capacities up to 50 bar and temperatures up to 225°C
- Cooling media: clean water or ethylene glycol

### Oil/Air Coolers

- In-line Oil air cooler for industrial use. Available in 10 different sizes
- Maximum operating pressure 16 bar
- 1-way and 2-way available with SAE flange
- Off-line version also available

### Shell & Tube Coolers

- Our EKM coolers provide a cooling surface up to 4x greater than a standard shell and tube cooler
- Cooling capacity up to 1000 kW
- Pressure resistant up to 35 bar
- Removable end caps for easy cleaning

## Hydraulic Gear Pumps

UK Flowtechnik now offer high quality gear pumps for hydraulic system and power pack applications, competitively priced and available from stock. They can be supplied bare shaft or complete with bellhousing, coupling and AC motor to suit.

A heritage of over 30 years experience in the manufacture of these products has produced a compact, rugged and efficient design in either aluminium or cast iron.

Group 1, 2 and 3 sizes can be specified with a choice of keyed, splined or tapered shaft options. Offering pressure ratings up to 250 bar, displacements from 0.6 to 90 cc/rev and also with bi-directional options, these pumps are a solid addition to your hydraulic system design.

### Group 1 Pumps

- Displacements from 0.6 to 13.5 cc/rev
- Flow rates from 0.87 to 19.5 l/min at 1450 rpm\*
- Mounting flanges: SAE "AA" 2 bolt, US 4F-17 4 bolt, European 4 bolt and "through bolt" front manifold discharge DC power pack design
- Side ports standard, rear ports available



### Group 2 Pumps

- Displacements from 4 to 33 cc/rev
- Flow rates from 5.8 to 47.8 l/min at 1450 rpm\*
- Mounting flanges: SAE "A" 2 bolt and 4 bolt European standard
- O ring side ports standard, rear ports available



### Group 3 Pumps

- Displacements from 18 to 90 cc/rev
- Flow rates from 26.1 to 130.5 l/min at 1450 rpm\*
- Mounting flanges: SAE "A" and SAE "B" 2 bolt and 4 bolt European standard
- O ring side ports standard, rear ports available



\*Subject to pressures & viscosity





# UK Flowtechnik

Specialists in flow metering, pumps, couplings  
and process measurement equipment

## We also offer:

- Flow meters & instrumentation
- Pump systems
- Magnetic drives
- Pressure and level sensors
- Temperature and density sensors



Call us on: **0800 433 4770** for more info and our other brochures in the range...



For all enquiries, please contact:

UK Flowtechnik Ltd  
1 Central Park  
Lenton Lane  
Nottingham  
NG7 2NR

UK Freephone: **0800 433 4770**  
Telephone: **+44 (0) 115 901 7111**  
Fax: **+44 (0) 115 986 8875**  
Website: **[www.ukflowtechnik.com](http://www.ukflowtechnik.com)**  
Email: **[sales@ukflowtechnik.com](mailto:sales@ukflowtechnik.com)**